

5-FU Dose Optimization Test

Sampling Instructions

Following these instructions will avoid delays in the OnDose™ testing process and ensure specimen integrity.

COLLECTING

a sample for OnDose™

NOTE: Upon receipt of sample kit, place gel packs in a -15°C freezer at least 24 hours prior to shipping patient's sample.



1. Complete the OnDose Test Request Form (TRF).
 - Complete with exact infusion start time, draw time, and infusion duration



2. Draw peripheral venous blood into a supplied 6-mL K2-EDTA Vacutainer® tube.
 - Collect blood sample **2 hours after the beginning of continuous infusion to the end of infusion** (as long as pump is still running)
 - Use only the K2-EDTA tubes provided in the test kit. Label blood tube with appropriate patient identifiers



(pink-topped tube)

3. **Immediately place sample on ice for a minimum of 5 minutes.**
 - Centrifuge sample (1500 g–2000 g x 10 minutes) within 45 minutes of drawing blood
 - **Immediately remove** sample from centrifuge and proceed to Step 4

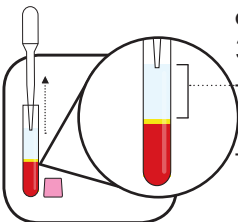

4. **Carefully draw at least 1 mL** of plasma with the supplied disposable pipette and transfer plasma into a supplied 3-mL Cryovial® tube.

- Collect at least **1 mL** of clear plasma fraction **from the top**
- Fill the pipette by squeezing the bulb before inserting the tip into the Cryovial tube. **Slowly release the bulb** once the pipette tip is just beneath the top of the clear plasma layer and track down as plasma is being drawn
- **Collect no more than half of the clear plasma layer.** Aspirate only once to avoid disturbing the buffy coat/cellular layer between the plasma and red blood cells
- Transfer the plasma sample into a supplied 3-mL Cryovial tube

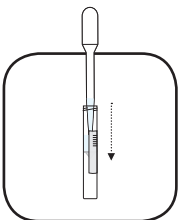

(white-topped tube)

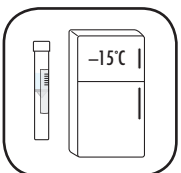

5. Mark the provided bar code label with the patient's name and date of birth (bar code is located at the top of the OnDose TRF). Attach the bar code lengthwise on the plasma tube.
 - Plasma sample must be frozen overnight before shipping

SENDING

the sample to Myriad for analysis

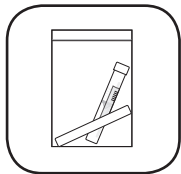

1. Place the frozen, labeled Cryovial white-topped tube into the supplied small ziplock bag with the absorbent strip. Next, place this frozen bagged sample into the supplied biohazard specimen bag.

- Include the completed OnDose™ TRF and all applicable insurance paperwork in the outer pouch of the biohazard specimen bag
- If insurance is to be billed, include the following:
 - A copy of both sides of the patient's insurance card(s)
 - Patient signature on the OnDose TRF
 - Applicable insurance-specific forms (eg, signed Medicare Advanced Beneficiary Notice of Noncoverage)

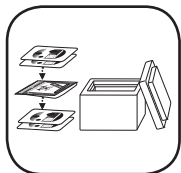

2. Place the double-bagged frozen sample with applicable paperwork into the supplied styrofoam package with the frozen gel packs for cold shipping. Assemble as follows:

- Place 2 frozen gel packs on the bottom of the styrofoam package
- Place the bagged frozen sample on top of the gel packs; next, sandwich the sample by placing **2 additional** gel packs on top of the sample
- Place lid on the styrofoam package and place the package securely in the shipping carton
- Seal the shipping carton and label it with the provided FedEx® airbill and sticker stating, "UN3373 Biological Substance, Category B"



3. Send the prepaid FedEx cold package to Myriad (address provided on the FedEx airbill).
 - If you do not have a scheduled FedEx pickup, call 1-800-GO-FEDEX (1-800-463-3339)

NOTE: FedEx and shipping regulations require diagnostic shipments be packaged in accordance with International Air Transport Association Packaging Instruction 650 and other applicable requirements. It is the shipper's responsibility to ensure the package conforms to these guidelines along with all applicable local, state, federal, and international regulations.

RECEIVING

your OnDose™ results



1. Your individualized report is generated and results are returned (**usually within 7 days**) in time to make therapeutic adjustments for the next cycle of treatment.

2. Refer to the OnDose Results Guide on how to interpret the OnDose report.

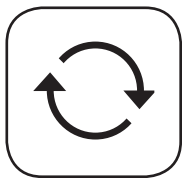

3. OnDose test results are used to help optimize an individualized dose for the next cycle of 5-FU chemotherapy.

- For the following cycles, repeat the test each time until desired area under the curve (AUC) range is reached and maintained for **at least 3 cycles**
- After maintaining target AUC levels for **at least 3 cycles**, monitor every third cycle

Any questions? Call **1-800-469-7423** and ask for an Account Executive in your area.

Cryovial is a registered trademark of Simport Plastics, Ltd.

FedEx is a registered trademark of Federal Express Corporation.

Vacutainer is a registered trademark of Becton Dickinson and Company.

Myriad, the Myriad logo, OnDose, and the OnDose logo are either trademarks or registered trademarks of Myriad Genetics, Inc., in the United States and other jurisdictions.

www.Myriad.com

Myriad Genetic Laboratories, Inc., 320 Wakara Way, Salt Lake City, UT 84108

© 2009 Myriad Genetic Laboratories, Inc. ODINSTRWEB/06-09

